

SEE SHEET 17

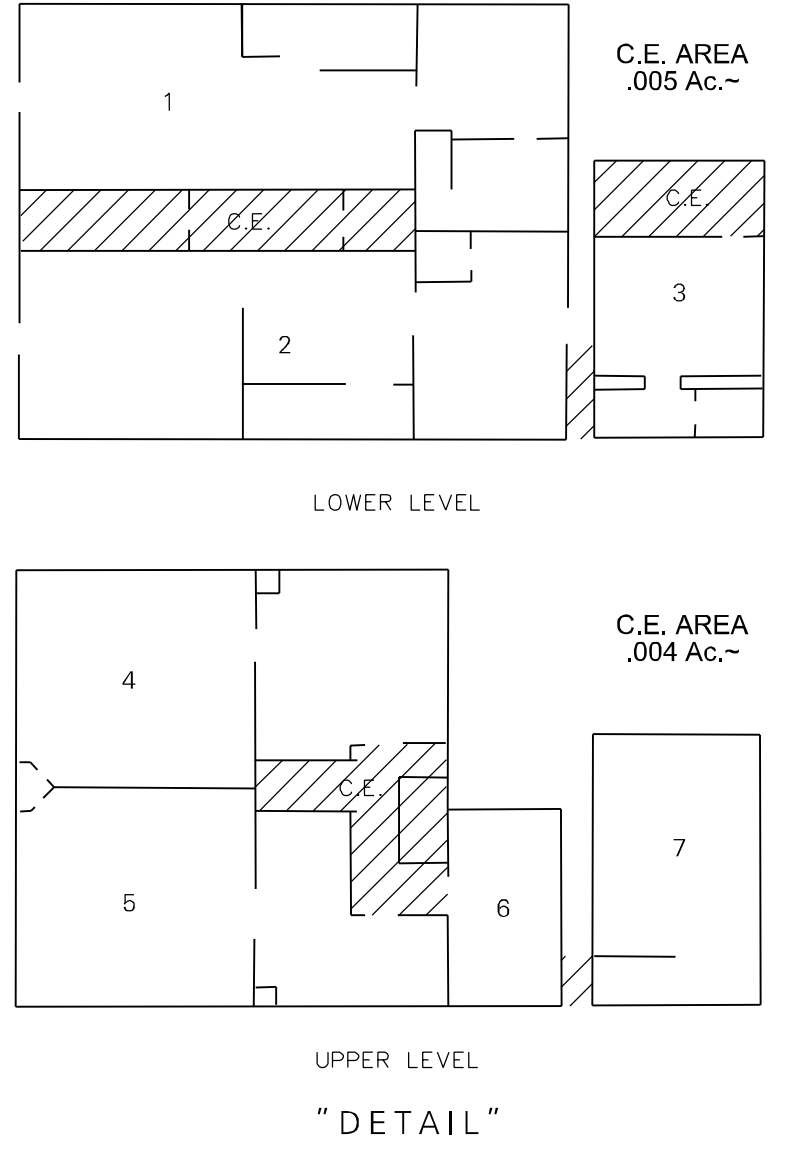
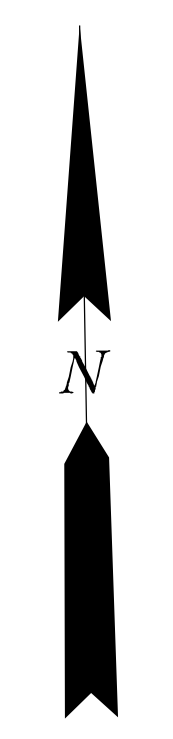

(19) - DENOTES HOUSE NUMBERS

THIS SHEET WAS FORMALLY APPROVED ON MARCH 12, 1985 BY IVAN HATHOWITZ AND ASSIGNED SERIAL NUMBER 641

DATE	NAME OF P.L.S.	LICENSE # OF P.L.S.
1/17/07	PATRICK S. VITARELLI	N.J.P.L.S. *27895
4/16/08	PATRICK S. VITARELLI	N.J.P.L.S. *27895
5/14/08	PATRICK S. VITARELLI	N.J.P.L.S. *27895
3/1/10	PATRICK S. VITARELLI	N.J.P.L.S. *27895
12-31-13	STEVEN C. WOODROW	N.J.P.L.S. #27514

NOTE:
ALL ACREAGE GIVEN ON THIS MAP DOES NOT INCLUDE ROAD AREAS.

THIS SHEET IS A DIGITIZED COPY OF THE TAX MAP ORIGINALLY PREPARED BY: B. HAROLD WILLS THE ORIGINAL IS ON FILE IN THE OFFICE OF THE TOWNSHIP ENGINEER

TAX MAP

MEDFORD TOWNSHIP

BURLINGTON COUNTY, NEW JERSEY
SCALE: 1"=50' DATE: JAN., 1959
B. HAROLD WILLS TOWNSHIP ENGINEER
MT. HOLLY, NEW JERSEY