

DATE	NAME OF P.L.S.	LICENSE # OF P.L.S.
9/29/06	PATRICK S. VITARELLI	N.J.P.L.S. #27895
4/09/09	PATRICK S. VITARELLI	N.J.P.L.S. #27895
7/15/09	PATRICK S. VITARELLI	N.J.P.L.S. #27895
9/09/09	PATRICK S. VITARELLI	N.J.P.L.S. #27895
2/28/11	PATRICK S. VITARELLI	N.J.P.L.S. #27895
9/7/11	PATRICK S. VITARELLI	N.J.P.L.S. #27895
9/08/16	CHARLES L. WALTON, JR.	NJPE&LS #15800
4/20/17	CHARLES L. WALTON, JR.	NJPE&LS #15800
11/1/17	CHARLES L. WALTON, JR.	NJPE&LS #15800

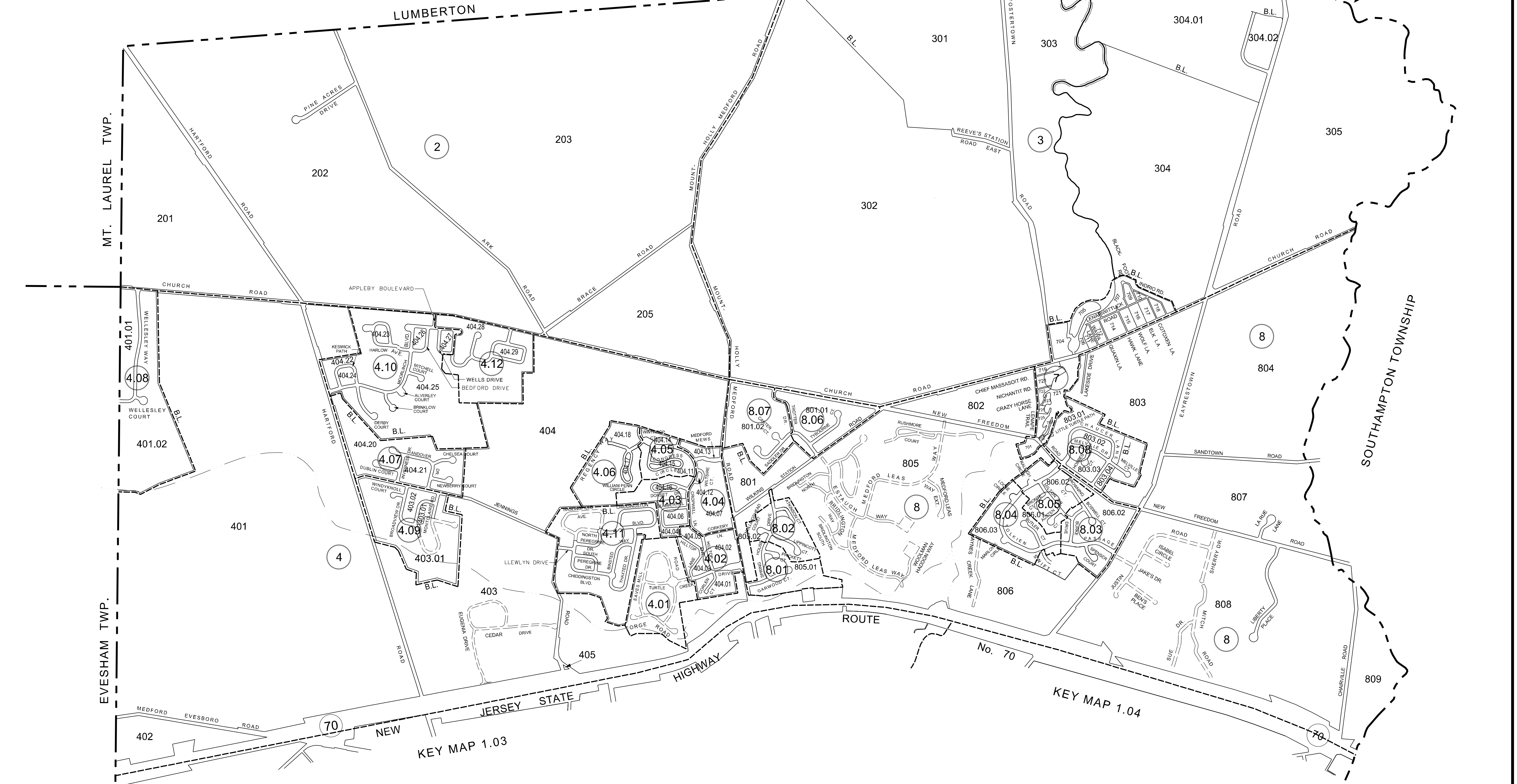

THIS SHEET IS A DIGITIZED COPY OF THE TAX MAP ORIGINALLY PREPARED BY: B. HAROLD WILLS THE ORIGINAL IS ON FILE IN THE OFFICE OF THE TOWNSHIP ENGINEER

NOTE: THE AREAS, BOUNDARIES AND DIMENSIONS, SHOWN ON THIS TAX MAP, ARE DERIVED FROM GROUND SURVEYS, AERIAL SURVEYS, AND RECORDED PLANS, MAPS, DEEDS, WILLS, AND ARE TO BE USED FOR ASSESSMENT PURPOSES ONLY.

NOTE: THIS TAX MAP SUPERSEDES THE TAX MAP APPROVED MARCH 12, 1985

- LEGEND**
- MUNICIPAL LINE
 - SHEET LIMIT LINES
 - ROW/LOT LINES/BLOCK LINES
 - UNIMPROVED/FUTURE/PRIVATE ROADS
 - ④ SHEET NUMBERS
 - 401 BLOCK NUMBERS

I HEREBY CERTIFY THAT THIS MAP AND ANY REQUIRED SURVEY HAS BEEN REVISED UNDER MY IMMEDIATE SUPERVISION, AND COMPLIES WITH THE LAWS OF THE STATE OF NEW JERSEY

PATRICK S. VITARELLI N.J.L.S. 27895

TAX MAP
TOWNSHIP OF MEDFORD
 BURLINGTON COUNTY, NEW JERSEY
 SCALE: 1"=800' DATE: JAN. 1959
B. HAROLD WILLS TOWNSHIP ENGINEER
 MT. HOLLY, NEW JERSEY
 TO SHOW CONDITIONS AS OF 11/1/17