

DATE	NAME OF P.L.S.	LICENSE # OF P.L.S.
8/01/06	PATRICK S. VITARELLI	N.J.P.L.S. *27895
9/29/06	PATRICK S. VITARELLI	N.J.P.L.S. *27895
5/05/08	PATRICK S. VITARELLI	N.J.P.L.S. *27895
1/20/09	PATRICK S. VITARELLI	N.J.P.L.S. *27895
4/09/09	PATRICK S. VITARELLI	N.J.P.L.S. *27895
10/31/16	CHARLES L. WALTON, JR.	N.J.P.L.S. *15800
4/20/17	CHARLES L. WALTON, JR.	N.J.P.L.S. *15800

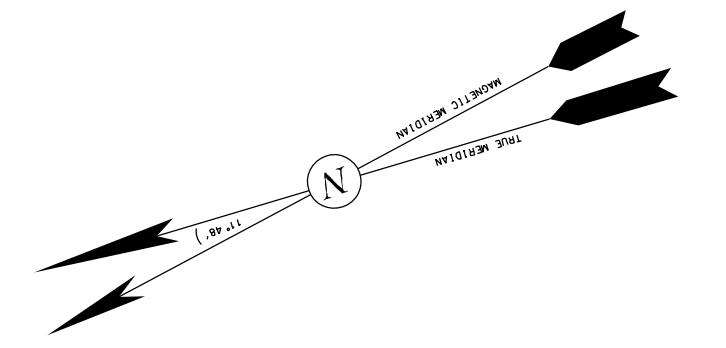

LEGEND

- COUNTY LINE
- MUNICIPAL LINE
- SHEET LIMIT LINES

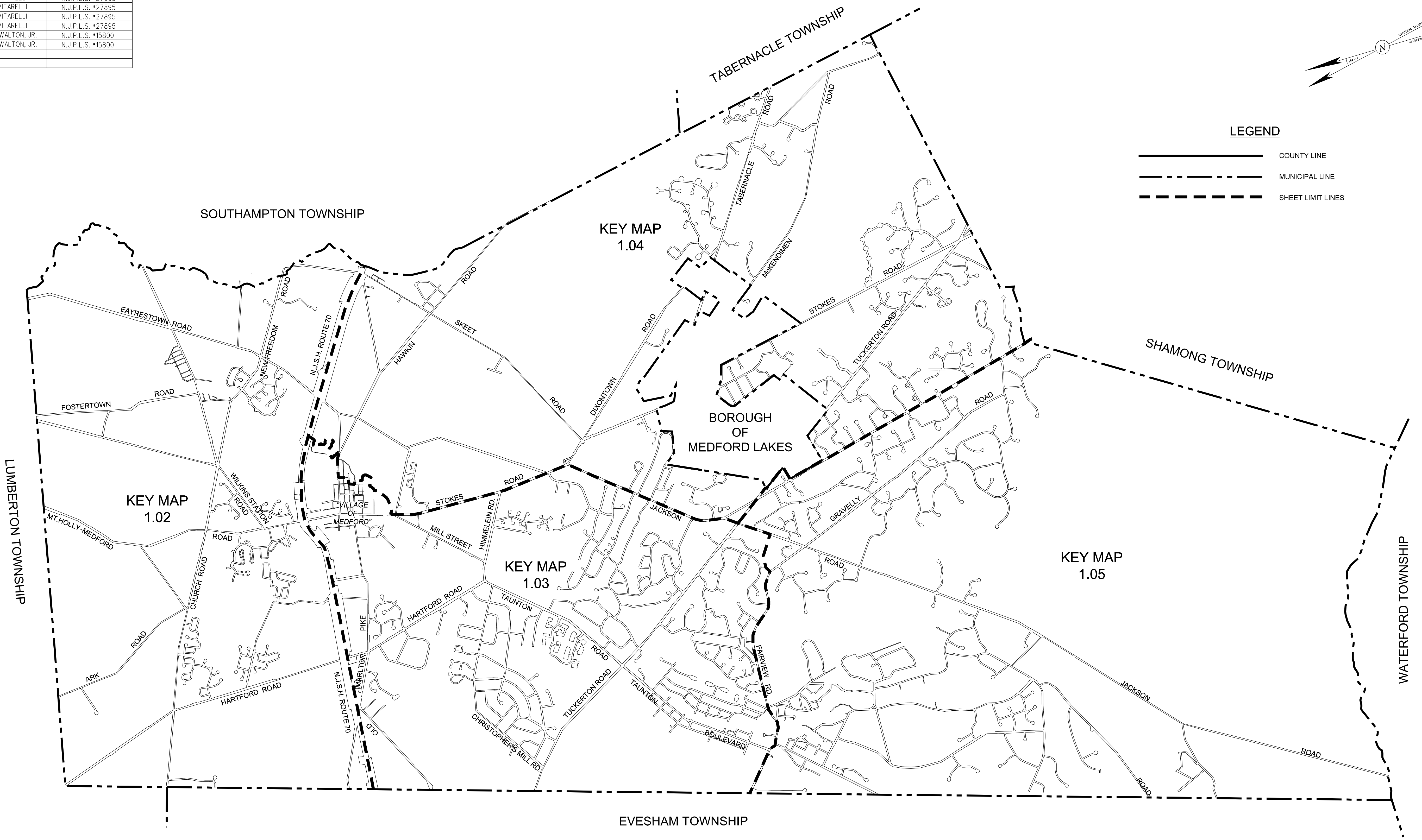

NOTE:
ALL ACREAGE GIVEN ON THIS MAP DOES NOT INCLUDE ROAD AREAS.

NOTE:
THE AREAS, BOUNDARIES AND DIMENSIONS, SHOWN ON THIS TAX MAP, ARE DERIVED FROM GROUND SURVEYS, AERIAL SURVEYS, AND RECORDED PLANS, MAPS, DEEDS, WILLS, AND ARE TO BE USED FOR ASSESSMENT PURPOSES ONLY.

NOTE:
THIS TAX MAP SUPERSEDES THE TAX MAP APPROVED MARCH 12, 1985

THIS SHEET IS A DIGITIZED COPY OF THE TAX MAP ORIGINALLY PREPARED BY: B. HAROLD WILLS THE ORIGINAL IS ON FILE IN THE OFFICE OF THE TOWNSHIP ENGINEER

MEDFORD TOWNSHIP WAS TAKEN FROM EVESHAM TOWNSHIP IN 1847, PAGE 16. THE FOLLOWING WERE SET OFF IN WHOLE OR IN PART FROM MEDFORD TOWNSHIP:
SHAMONG TOWNSHIP - 1852, PAGE 64
LUMBERTON TOWNSHIP - 1860, PAGE 248
MEDFORD LAKES BOROUGH - 1939, PAGE 93
NOTE: DATE AND PAGE REFER TO REVISED STATUTES OF NEW JERSEY

I HEREBY CERTIFY THAT THIS MAP AND ANY REQUIRED SURVEY HAS BEEN REVISED UNDER MY IMMEDIATE SUPERVISION, AND COMPLIES WITH THE LAWS OF THE STATE OF NEW JERSEY

PATRICK S. VITARELLI N.J.L.S. 27895

TAX MAP
TOWNSHIP OF MEDFORD
BURLINGTON COUNTY, NEW JERSEY
SCALE: 1"=2000' DATE: JAN. 1959
B. HAROLD WILLS TOWNSHIP ENGINEER
MT. HOLLY, NEW JERSEY

TO SHOW CONDITIONS AS OF 4/20/17